

# FM-200 Component Description

Effective: April 1999

K-90-5201

## Pressure Trip Applications - Installation Detail

### INSTALLATION DETAIL

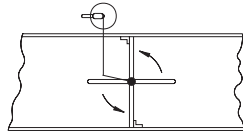

HORIZONTAL DUCT DAMPER

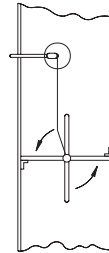

VERTICAL DUCT DAMPER

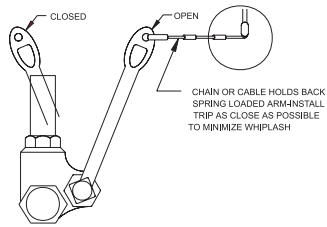

SPRING LOADED LIQUID OR GAS SHUTOFF VALVE

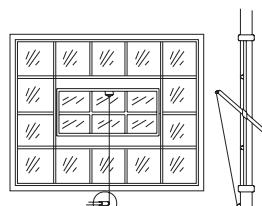

WINDOW-EITHER WEIGHTED OR OFF BALANCE

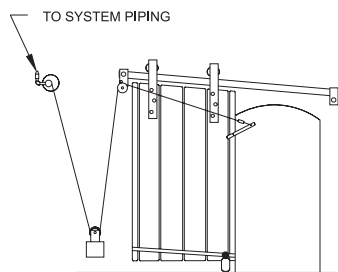

SLIDING DOOR

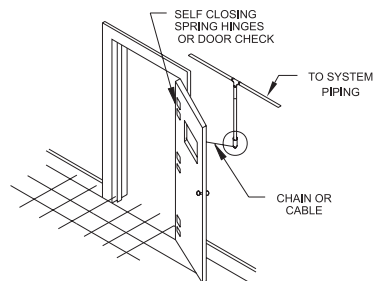

SWINGING DOOR-SELF CLOSING

This literature is provided for informational purposes only. KIDDE-FENWAL, INC. assumes no responsibility for the product's suitability for a particular application. The product must be properly applied to perform as described herein.

If you need more information on this product, or if you have a question, contact KIDDE-FENWAL, INC., Ashland, MA 01721. (508) 881-2000.

K-90-5201 4/99 ©1999 Kidde-Fenwal, Inc. Printed in U.S.A.

**KIDDE**<sup>®</sup>  
**Fire Systems**

KIDDE-FENWAL, INC.  
400 MAIN STREET, ASHLAND, MA 01721  
TEL: (508) 881-2000 FAX: (508) 881-8920