

Marine Suppression System

Architect and Engineering Specification

P/N C02-1230

- UL - Ex 4447
- ULC - CEx 1312
- FM - 3002238
- USCG - 162.161/2/0 (FM-200)
- USCG - 162.038/12/0 (CO₂)

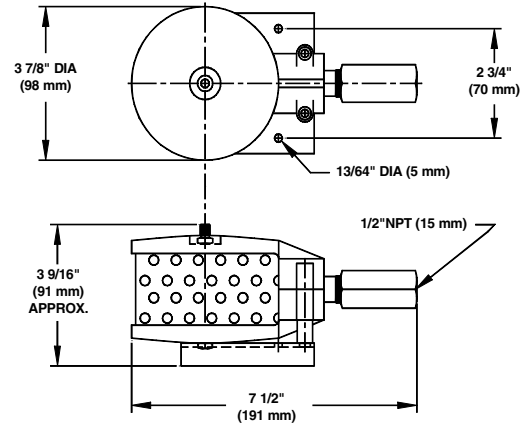
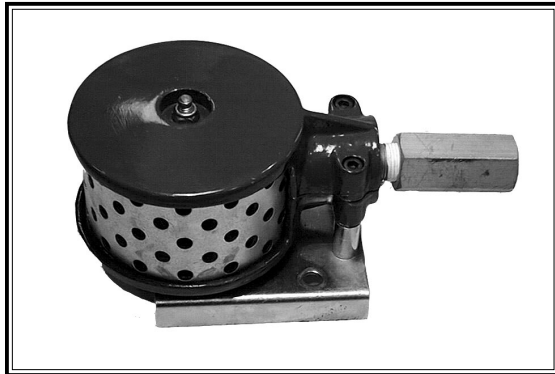

DESCRIPTION

The pressure operated siren is used to warn personnel of a system discharge. The siren is operated with the carbon dioxide pressure from the system. The siren is connected to the system piping using the 1/2" NPT connection located at the base of the siren. The pressure spins the turbine and sounds the siren from the beginning of the discharge throughout most of the discharge time.

The siren operates at a minimum decibel level of 90 dB at 10 ft. (3m). The siren requires a CO₂ flow rate of 5.2 lbs. / min. (2.4 kg / min.) The siren is constructed of brass and finished with red, corrosion resistant paint.

SPECIFICATIONS

Materials: Pneumatic Siren - Brass
Mounting Plate - Stainless Steel